

Installation Instructions:

1. Ensure within aperture is clean and free of debris loose cement, and remove all dust from surfaces requiring installation.
2. Wrap insulated pipe with 2 layers of FP302 Intustrap and secure in proposed position of FB750 Intubatt.
3. Wrap combustible pipe with FP302 Intustrap ensuring the correct number of layers are applied to the correct pipe size:
 - 1 layer up to 55mm diameter
 - 2 layers up to 82mm diameter
 - 3 layers up to 110mm diameter
4. Spread all cables and apply a good amount of FS702 Intumastic between cables (cable bundles up to 100mm diameter) at proposed position of FB750 Intubatt.
5. Cut FB750 Intubatt to tightly fit into aperture.
6. Cut FB750 Intubatt at mid-point of services and shape to fit around service, to form a tight joint around the penetration/FP302 Intustrap.
7. Apply FS702 Intumastic to the cut out for penetration within the FB750 Intubatt.
8. Apply FS702 Intumastic brush grade to all edges of FB750 Intubatt.
9. Fit one half of the FB750 Intubatt into the opening.
10. Continue to fit remaining pieces of FB750 Intubatt ensuring all joints finish flush and items like FP302 Intustrap are central within the FB750 Intubatt.
11. Coat all joints, exposed edges of FB750 Intubatt and damages to coating with FS702 Intumastic brush grade.
12. Apply FS702 Intumastic bead to all FB750 Intubatt interfaces/ joints.

Note: Single layer FB750 Intubatt detail may perform to 120 minutes integrity and 60 minutes insulation FB750 Intubatt only, insulation as per service detail.

Where single layer detail is adopted, aperture must be framed and lined as per dry-lining manufacturers recommendations.

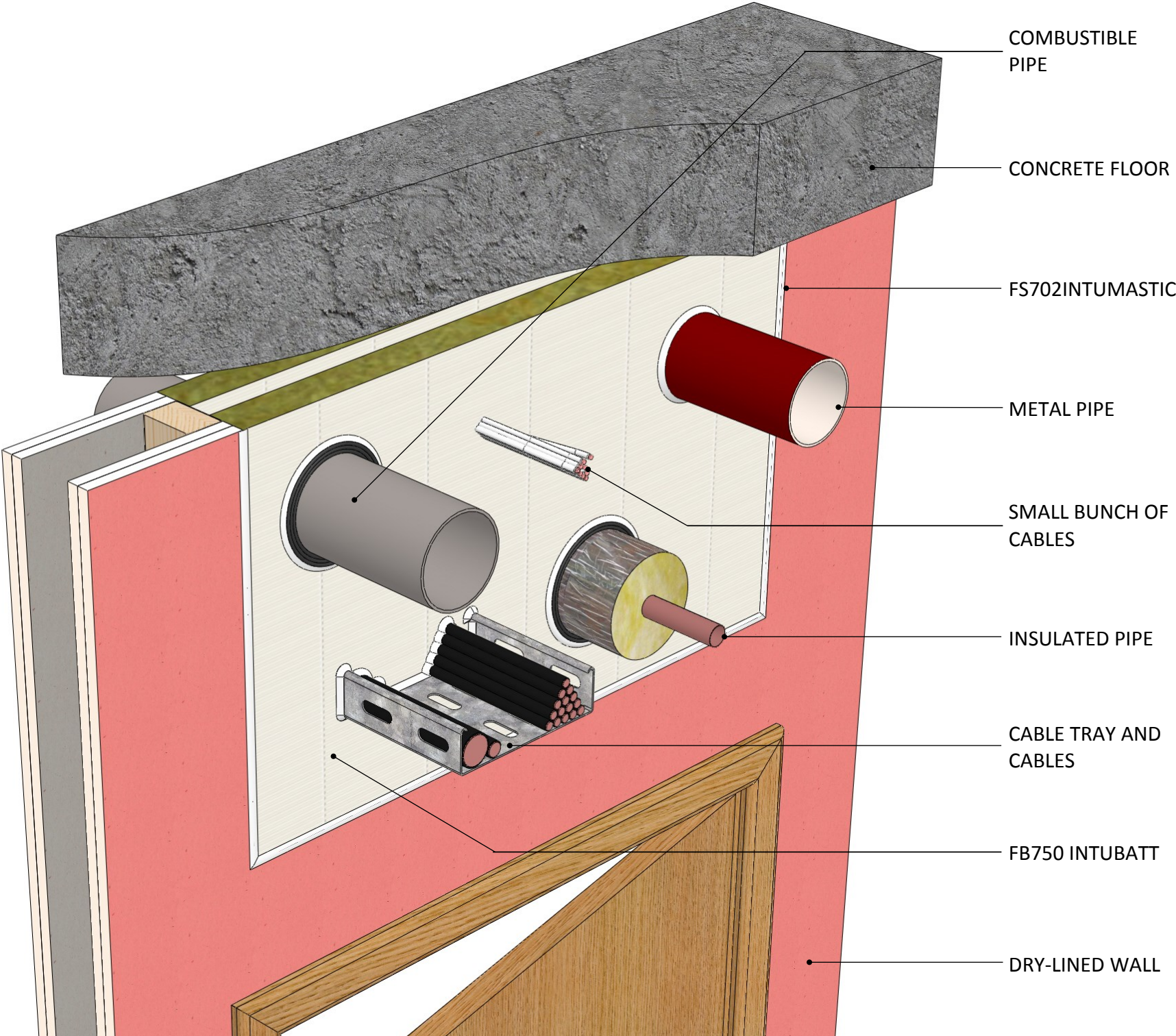

Additional Notes:

Please refer to Nullifire Preapplication Guidance Note or if any further queries contact the Nullifire Technical Department. All surrounding substrates must perform to an equal or greater fire performance than the fire seal.

Details will only perform to the substrates performance capabilities. This applies to fire and acoustic.

Soffit deflection &/or movement to be considered. If services are rigidly fixed to a moving soffit, they may also require movement details within the batt seal.

Test Information:

Standard (Ref): Ad-hoc (Elements tested to BS EN 1366 - 3)

Products: FB750 INTUBATT, FP302 INTUSTRAP, FS702 INTUMASTIC

Scenario: Various penetrations through wall construction over door panel, suitable for block-work and dry-lined walls.

Penetrations: As illustrated.

Void Size: 1190mm x unlimited length. If larger then framework required.

Fire Resistance: Up to: Integrity (E) 120 mins
Insulation (I) 60 mins

Insulation performance may be affected by penetration type and size. FI025 Intuflex maybe required to improve (I) value.

Acoustic: Test: BRE 224463
FB750 Intubatt 1,Two Layers
Void 1.0m2 : 59 dB

Test: BMTrada Z/12017

FB750 Intubatt 2, One Layer
Void 0.6m2 : 36 dB

FB750 Intubatt 2,Two Layers
Void 0.3m2 : 57dB
Void 0.6m2 : 50 dB

Drawing Title:

OVER DOOR FIRE-STOP WITH VARIOUS SERVICES WITHIN DRY-LINED WALL.

Drawing Reference No:

PS011
A3